

Hose2Go

Constant Pressure Water Supply Unit



OPERATOR'S MANUAL

Contents

INTRODUCTION	3
DISCLAIMER	3
ABOUT THIS MANUAL.....	4
KEY TERMS.....	4
PRODUCT INFORMATION	5
SAFETY INFORMATION	5
DECALS.....	6
PRODUCT DESCRIPTION AND SPECIFICATIONS	6
OPERATION	8
BEFORE USE	8
MAINTENANCE	10
General Recommendations:	11
Hose2Go Specific Maintenance	11
STORAGE.....	12
TROUBLESHOOTING	14
LIMITED WARRANTY	15
WARRANTY: (Ex-factory/ Reseller premise)	15
Warranty exclusions:	15
Normal Wear	15
Installation, Use and Maintenance	16
Other Exclusions	16
Responsibility of the consumer under this Limited Warranty:	16
Claim Procedure:	16
WARRANTY CONTACT INFORMATION:	17
CONTACT INFORMATION	18

INTRODUCTION

Thank you for purchasing a MAKINEX product.

This manual provides information and procedures to safely operate and maintain the *Hose2Go*. For your own safety and protection from injury, carefully read, understand and observe the safety instructions described in this manual.

Keep this manual or a copy of it with the machine. If you lose this manual or need an additional copy, please contact MAKINEX. This machine is designed and built with user safety in mind; however, it can present hazards if improperly operated and serviced. Please follow the operating instructions carefully. If there are any questions regarding operating or servicing of this machine, please scan QR code or contact MAKINEX.

The information contained in this manual was based on machines in production at the time of publication. Makinex reserves the right to change any portion of this information without notice.

All rights, especially copying and distribution rights are reserved.

Copyright 2016 by MAKINEX

No part of this publication may be reproduced in any form or by any means, electronic or mechanical, including photocopying, without express written permission from MAKINEX

Any type of reproduction or distribution not authorised MAKINEX represents an infringement of valid copyrights and will be persecuted. We expressly reserve the right to make technical modifications, even without due notice, which aim at improving our machines or their safety standards.

DISCLAIMER

MAKINEX and its affiliates take no responsibility for any damage, injury or death resulting from the incorrect or unsafe use of this product. Use of this product should be undertaken by competent persons only. It is the operator's responsibility to ensure that the following safety procedures are followed. If you are unsure, do not operate this product.

Record the model and serial numbers as well as date and place of purchase for future reference. Have this information available when ordering parts and when making technical or warranty inquiries

MAKINEX SUPPORT

+61 2 9460 8071 (AUS)

855-625-4639 (USA)

MODEL NO.

H2G

SERIAL NO.





DATE OF PURCHASE

PURCHASE LOCATION

ABOUT THIS MANUAL

This manual uses the following symbols to help differentiate between different kinds of information. The safety symbol is used with a key word to alert you to potential hazards in operating and owning Hose2Go. Follow all safety messages to avoid or reduce the risk of serious injury or death.

KEY TERMS

 READ CAREFULLY	READ CAREFULLY – refers to <i>important information</i> that should be paid careful attention.
 CAUTION	CAUTION - indicates a potential hazardous situation which, if not avoided, <i>may</i> result in minor or moderate injury
 WARNING	WARNING – indicates a potentially hazardous situation which, if not avoided, <i>could</i> result in death or serious injury
 DANGER	DANGER – indicates an imminently hazardous situation which, if not avoided, <i>will</i> result in death or serious injury
 PROHIBITED	PROHIBITED – identifies actions that <i>should never</i> be carried out by any one interacting with the machine.

PRODUCT INFORMATION

SAFETY INFORMATION



Read this manual **thoroughly** before operating your Hose2Go. Failure to follow instructions could result in serious injury or death.



MAKINEX Hose2Go is designed for ease of use and safety. However, damage to the device and personal injury is possible if used incorrectly. Instruct all operators in care and use of the machine before use.



RISK OF EXPLOSION

Contents of device are under pressure (even when empty). **Do not attempt to disassemble device** as serious injury may occur. Warranty is void if disassembled (other than by registered service agent).



RISK OF EXPLOSION OR DAMAGE TO DEVICE

Device is designed for use on water main's pressure and has been tested to 70 Psi. Do not connect to sources which you feel may exceed this pressure. i.e. stand pipe into water main, hydrant without pressure reducer, irrigation pump, etc. Doing so will void warranty.

- ALWAYS wear personal protective appropriate to task; such as goggles, ear muffs, gloves, and closed foot wear.
- ALWAYS use Makinex branded hose fittings as they are tested at rated pressure use of non-genuine accessories may reduce performance and/or working life of device.
- ALWAYS use care in filling tanks to that a firm connection is made between connectors.
- ALWAYS Make sure and connectors/hose are free of debris that could obstruct/damage device.
- NEVER introduce foreign agents (i.e. soaps, solvents, colours, etc.) to device. Doing so will void warranty.
- ALWAYS follow manufacturer's recommendations, including those of equipment used in conjunction with Hose2Go (for example; Concrete saw User's manual)



WARNING

RISK OF FALL HAZARD

- Use of Hose2Go can create puddles and slippery surfaces.

- Keep operating area clear of obstacles.
- DO NOT operate the machine with missing, broken, or non-genuine parts.
- DO NOT drag the device using only the hose as this may cause damage to the device and/or fittings.
- NEVER spray near power source.



WARNING

RISK OF ELECTRICAL SHOCK

- Risk of electrocution.
- Be aware of electrical hazards whilst performing task as contact with power source may cause electric shock.

DECALS



Serial # Decal



(On side)



(Concealed in base)

Do not attempt to disassemble



(At rear also)

PRODUCT DESCRIPTION AND SPECIFICATIONS

The MAKINEX Hose2Go is a constant pressure water supply device. It is designed and engineered to simplify the process of supplying water in situations where regular hosing is difficult. The Hose2Go includes a multi-function nozzle, an on/off valve, 3 metres of reinforced hose, all mounted on a compact two chamber frame design.

MAKINEX	
Hose2Go	
OVERALL WEIGHT - Empty	6kg/13.2lb
OVERALL WEIGHT – Full	20kg/44lb
OVERALL WIDTH	325mm/12.8inch
OVERALL HEIGHT	800mm/31.5inch
OVERALL DEPTH	144mm/5.7inch
HOSE LENGTH	3m/18ft
PRESSURE OUTPUT	7-10psi
FLOW RATE	Approx. 0.5 – 7.0 L/min (0.13 - 1.85 gal/min)

OPERATION

BEFORE USE

1. Inspect device

1.1 Check for any damage. Check for loose or missing fasteners (2 x nut/bolt in base 2 x screws in handle).



1.2 Ensure all fittings are tight (do not over tighten using tools as damage may occur to fittings).

NOTE: IMPROPER treatment of Hose2Go can damage it and shorten its working life. **DO NOT** attempt to open device to alter or to repair it. This must **ONLY** be done by Makinex approved service technician.

FILLING



Using high-pressure pumps, direct connection to water mains or other high-pressure sources to fill Hose2Go that exceed rated pressure (70 psi) will void warranty.

- Only** use water.
- DO NOT mix with oil, detergents, etc.
- DO NOT modify device in any way.

To fill Hose2Go, observe the following steps:

2.1 Attach hose adaptor to the tap

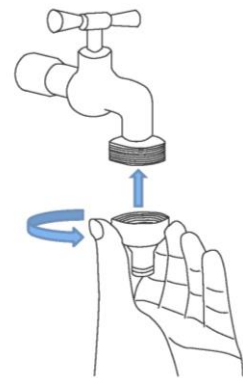

2.2 Attach the hose plug to a tap

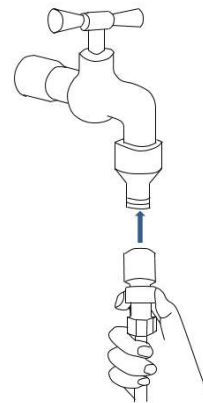

2.3 Turn tap on fully open

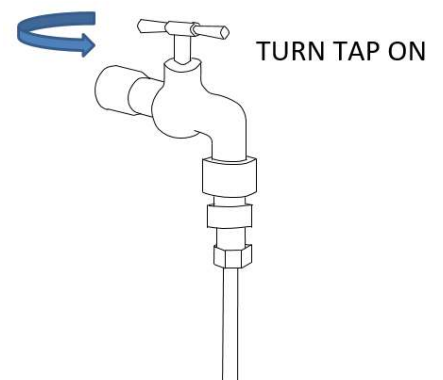

2.4 Allow Hose2Go to fill.

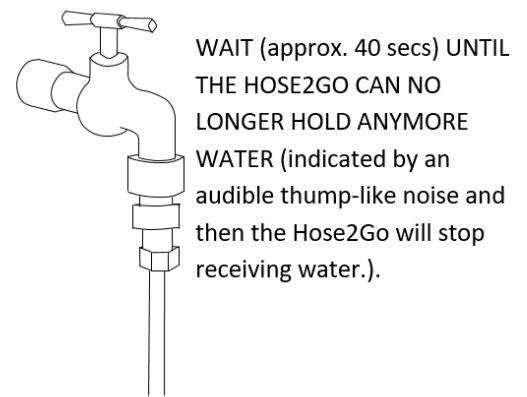

2.5 Turn tap off

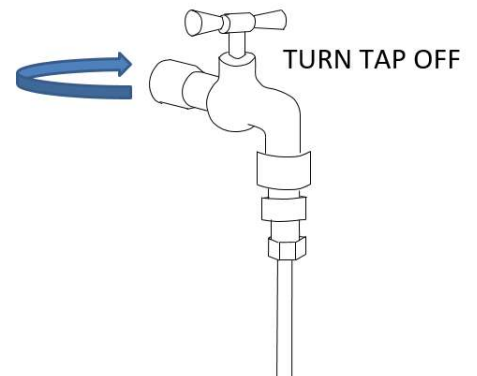

2.6 Remove the hose plug/connector from the tap

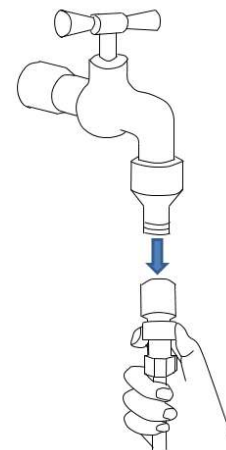

2.7 Connect the Hose2Go to desired application and use as required (i.e. concrete cutter, core drill, etc.)

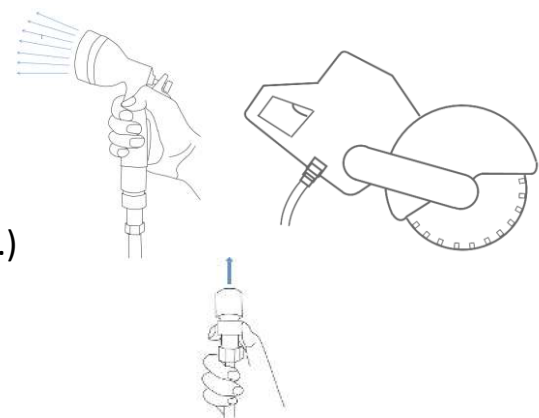

MAINTENANCE

General Recommendations:

Regular maintenance will improve the performance and extend the life of your MAKINEX product.

The Hose2Go warranty does not cover items that have been subjected to operator abuse or negligence or disassembly.

Should you have questions about replacing components on your Hose2Go, please contact dealer for assistance.

Hose2Go Specific Maintenance

This device is designed for the rigours of the construction industry. However, care is still required to maximise its working life. If the instructions in this manual are heeded, you can expect a long and rewarding service from your MAKINEX Hose2Go.

NOTE: IMPROPER treatment of Hose2Go can damage it and shorten its life.
--

Cleaning

Hose and wipe down Hose2Go using soapy water be cautious not to introduce debris into inner workings.

Using a high-pressure washer is **not** recommended as this could strip the decals on the device. Decals include important information such as serial number and instructions.

Do not clean internally with soaps or other cleaning agents, rinse with fresh water and empty to store.

Clear Debris

Before use, clear debris from hose line. If debris has entered the hose line disconnect from Hose2Go base (aware that if the device is full water will spray out)

and connect the free hose to a tap, flush out any debris before reconnecting and refilling Hose2Go.

Check multi spray nozzle

Ensure nozzle is connected securely and functioning correctly. Selector should rotate between options smoothly with a slight click at each function.

Check one-way valve

Inspect one-way valve on hose fitting and ensure it is working correctly. Ensure no debris is in mechanism.

Threaded fittings

Check threaded fittings are tight to ensure a good seal. Do not use hand tools to over tighten threaded fittings as damage may occur.

Tools can be used to **gently** loosen fittings on hose if required.

The barb fitting on the top lid of the device can be tightened/loosened by hand. Use cloth to improve grip if tight. Use of multi grip plyers may be required if too tight. Use gently avoiding damage to barb and Hose2Go top lid frame.



STORAGE

Long term storage instructions

It is not advised to store a **full** Hose2Go's for long periods (weeks/months) as this may reduce performance of your product. Empty your Hose2Go before long-term storage.

Do not clean inside tanks with soaps or other cleaning agents/products, rinse with fresh water and empty.

TROUBLESHOOTING

TROUBLE SHOOTING GUIDE		
PROBLEM	CAUSE	REMEDY
Pump does not fill	Valve faulty	Inspect valve on hose
	Blockage in hose	Remove hose from Hose2Go and flush with tap water from either end Check for blockages at barbed fittings
	Blockage in top cap	Inspect inlet for debris
Irregular variations in pressure	Machine being used has blockage	Refer to applicable machine's operator manual
	Valves blocked by debris	Clean the valves
	Air in system	Follow instructions on device to fill from empty
	Hose blocked by debris	Remove hose from Hose2Go and flush with tap water from either end
Pressure drop	Tank empty	Fill following procedure in manual/ and on Hose2Go
	Blockage in hose	Remove hose from Hose2Go and flush with tap water from either end
	Faulty valve	Inspect valves for blockages/damage
Water leaking from main housing	Ruptured bladder	Return to MAKINEX service department
	Cracked housing	Return to MAKINEX service department
	Water accumulated whilst stowed on side	When stowed on side or upside down water can accumulate in upper housing. This is normal do not confuse with leaking.

LIMITED WARRANTY

In order to take advantage of the MAKINEX limited warranty, you must have maintenance performed according to the schedule (contained in relevant owner's manual supplied with this product), by an authorised MAKINEX dealer or MAKINEX service technician.

In order to ensure your safety, we strongly recommend that you only use an authorised MAKINEX dealer for servicing. Only authorised MAKINEX dealers have access to all the special tools, technical information, parts and training required to maintain your MAKINEX product in peak operating condition.

MAKINEX warrants each new Hose2Go to be free from defects in material and workmanship under normal domestic and industrial use and service for the period specified below, conditional to the limitations and exclusions printed on this page. This warranty applies only to new MAKINEX Hose2Go's distributed by us and by our authorised MAKINEX dealers.

Our goods come with guarantees that cannot be excluded under the Australian Consumer Law. You are entitled to a replacement or refund for a major failure and compensation for any other reasonably foreseeable loss or damage. You are also entitled to have the goods repaired or replaced if the goods fail to be of acceptable quality and the failure does not amount to a major failure.

WARRANTY: (Ex-factory/ Reseller premise)

MAKINEX warrants to the original purchaser:

- External housing, internal workings, and fittings will be free of defects in material and workmanship for a period of (6) months from the original date of purchase.

Warranty exclusions:

This warranty does not cover the following repairs and equipment:

Normal Wear

The Hose2Go is designed for use in harsh environments, therefore, cosmetic damage including; scratches, minor dents/damage caused throughout use is considered "normal wear".

Installation, Use and Maintenance

This warranty will not apply to parts and/or labour if this Hose2Go is deemed to have been misused, neglected, involved in an accident, abused, loaded beyond the Hose2Go's limits, modified, installed improperly or connected incorrectly to any water supply. Normal maintenance such as cleaning, adjustments to fittings, obstruction due to build-up is not covered by this warranty.

Other Exclusions

This warranty excludes:

- Cosmetic defects such as, decals, etc.
- Failures due to acts of God and other force majeure events beyond the manufacturer's control.
- Problems caused by parts that are not original MAKINEX parts.

Responsibility of the consumer under this Limited Warranty:

- Only clean, potable water should be used through our Hose2Go with pressure not exceeding 70psi.
- Maintenance services are not covered under warranty.
- It is the consumer's responsibility to deliver the device in question to our service premises or to the premises of our appointed agent at the consumer's expense for replacement or repair as applicable.

Claim Procedure:

- Contact MAKINEX by phone or email informing us of your machine's problem or defect.
- Once the extent of the claim has been assessed, we retain the right to compensate the consumer for such defect, or repair (parts & labour), or replace the machine under warranty.
- All warranties will be carried out by MAKINEX authorised staff or appointed agents at a premises to be determined by the Manufacturer.
- Transportation charges on product submitted for repair or replacement under this warranty are the sole responsibility of the purchaser. This warranty only applies to the original purchaser and is not transferable.
- It is the responsibility (and cost) of MAKINEX or our appointed agent to return the device to be repaired or replaced under warranty to the consumer- this is valid for domestic territories only (e.g. Australian units will be delivered within Australian territory, USA units will be delivered within USA territory and European units will be delivered within its designated country's territories).

- Warranty calls will only be carried out by our representatives and not via client's choice of repairer. We will not accept back charges for any work not carried out by our representatives, or accept any charges due to equipment being un-operational for any reason even during its warranty period.

WARRANTY CONTACT INFORMATION:

AUSTRALIA

Tel + 61 2 9460 8071

Fax +61 2 9439 9815

d.lobban@Makinex.com.au

15 Waltham St, Artarmon, NSW
2064 AUSTRALIA

USA

Tel 855-625-4639

Makinex.com

EUROPE

Tel +31 (0)6 24881203

+31 (0)6 50841849

SERVICE & PART ORDERING

For service and ordering parts, please call

AUS: 1300 795 953 or +61 2 9460 8071

USA: 855 625 4639

EUROPE: +31 (0)6 24881203 or +31 (0)6 50841849

Or your nearest MAKINEX distributor

We have very knowledgeable, experienced staff to assist you with help and advice.

CONTACT INFORMATION



AUSTRALIA/ NEW ZEALAND
UNITED STATES OF AMERICA
EUROPE

W makinex.com
E sales@makinex.com