

Operation manual

The **ROLL-STRIPPER RO-2**

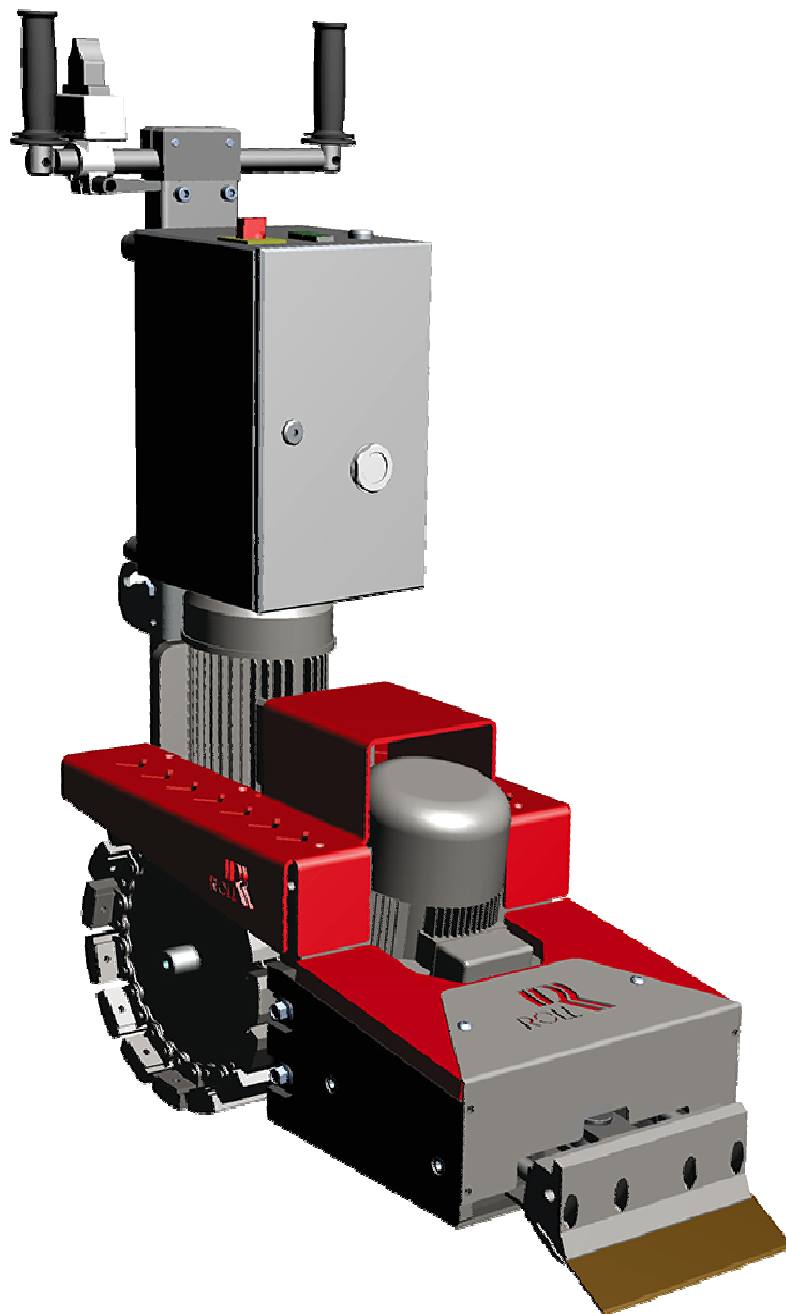

The operation manual identify important notes on safety and damage prevention using the following symbols:



Please comply with these instructions to avoid any damages and injuries. They point to a possible dangerous situation. The nonobservance can lead to the death, to heavy injuries and to material damages.

No liability for the damages which originate from the use of these operating instructions.  
Changes reserve.

### **Roll GmbH**

Flooring technology  
Albstr. 12  
D-72820 Sonnenbühl  
Germany

Phone: +49(0)7128-92800  
Fax: +49(0)7128-928011  
E-Mail: [info@roll-gmbh.de](mailto:info@roll-gmbh.de)  
<http://www.roll-gmbh.de>

State: April 2015



The operation manual identify important notes on safety and damage prevention using the following symbols:



### **Warning!**

Designates a potentially hazardous situation.  
Please note that failure could cause death or injuries.



### **Caution!**

Designates a dangerous situation.  
Please note that failure could cause damages at products or others.



### **Note!**

*Important notes on the operation, intended for an optimum utilization of the equipment and other useful information.*

*The operation manual is intended to **accompany the machine**.*

*The operation manual has been prepared by the manufacturer on the basis of his knowledge and experience with respect to design, production and operation.*

*Specific instructions of the user may be added to these operation manual (for example to refer to surveillance and reporting regulations, inter-company maintenance and inspection schedules. The inspection intervals are in accordance with VBG 4 §§ 3 and 5 und § 20 GefStoffV (Regulations of hazardous materials)).*

## **1.1 General notes for the operator**

As a operator you are responsible for:

- The proper and normal operation by trained persons only,
- The adherence to the safety regulations, the safety notes, and the provisions referring to working safety and accident prevention,
- The technical instruction of the operation personnel on the equipment and their reading of the operation instructions of the equipment.

## **1.2 Description of the ROLL-STRIPPER RO-2**

The ROLL-STRIPPER RO-2 is used for removing bonded floor coverings like linoleum, PVC, CV, vinyl, rubber, carpet, ceramic tiles and parquet in dry rooms.

The covering is removed by a pushing motion of the tool from the ground. (Stripper principle).

## **1.3 Storage**



### **Caution!**

Please store the machine dry.



Please store the machine with removed tool to avoid injuries!

## **2 Safety notes**

### **2.1 General information**

Adherence to the safety notes helps to protect against injuries and reduces the risk of an improper utilization of the machine. Every user of this machine and personnel charged with the assembly, maintenance or repair of this machine must have read and understood the contents of the instructions prior to starting any work.

### **2.2 Intended use**

The ROLL-STRIPPER RO-2 is designed for stripping bonded floor coverings such as linoleum, vinyl, rubber, caoutchouc, PU and PVC floors and carpet in dry rooms. Any other use is regarded considered improper use. The manufacturer is not liable for any damage resulting there from.

If the machine is used for purposes other than those intended, the manufacturer of the machine cannot be held liable for any damage to persons, property or pets resulting from such misuse.

### **2.3 General safety instructions**

The ROLL-STRIPPER RO-2 was designed and constructed for its intended use in accordance with the generally approved rules of technology, the industrial safety and accident prevention regulations, and the directive for the safety of machines of the EC.

- Certain dangers may be occurring during the operation of the machine despite all safety and security measures and facilities. This is especially true if
  - improper operation or
  - improper applicationare the cause.
- Failing to adhere to the operation instructions, in particular to the safety notes, will create danger of injuries or even of fatal injuries as also danger of damage to physical assets.



#### **Warning, Danger of electrical shocks**

**Do not use damaged lines and plugs.**

**The machine may be operated only in a technically flawless condition and with all safety facilities fully operational.**

### **2.4 Prerequisites for the user**

The users of the machine are required to

- be instructed with the operation of the machine,
- be familiar with and able to execute the operations required for the handling and assembly of the machine,
- be aware of and know the applicable safety regulations for the operation of such machines and adhere to these (cf. The chapter "Preliminary marks"),



- be informed about possible additional local (national) regulations (e.g. with respect to safety facilities),
- be informed about potential threats and dangers arising from the operation of such machines.

### 2.5 Inspection with accordance with VBG 4 § 5 (1) Nr. 2

The user is responsible for ensuring that the machine is inspected with respect to its proper operation in intervals of 6 months. The inspection may only be executed by a skilled electrician or by personnel that has been trained in electrical skills, provided that suitable measuring and test equipment is used.

### 2.6 Safety notes



**With nonobservance or disregard of these instructions heavy injuries and/or damages can be caused. Read and keep all safety notes.**



### 2.6.1 Safety notes electrical connection



#### **Warning! Danger of life!**

**When crossing and damaging the electrical cable: DANGER due to electric shock!**

**Perform a safety check prior to each start of the machine:**

- Inspect the connecting cables and connectors/pugs for damage and improper connected load.
- Route the electrical cables properly to prevent persons tripping over them.
- Do not switch on the machine until it is in working position.
- Hold the machine firmly with both hands at the handle.
- Switch of the machine immediately when the operation is completed.



Should there be problems with the electricity supply (protections, relays etc.) please contact a specified electrician.



Switch off and disconnect the machine for maintenance and repair.



Never use the machine with a defective cable; this can lead to an electric shock. Do not pull the machine at the cable. Use only intact plugs and cables.



It can come for injuries or deaths by electric shock if the cable is damaged. Hold the cable far from the lower part of the machine, so that it cannot get into contact with the blade. Lead the cable always to the back away.



Should the machine not be properly connected to the electric system, this can lead to deaths by electric shock. For a maximum protection against electric blows you use please an electric system with safety switch.

Use only approved cables with a cross section of  $3 \times 2,5^2$ . With the use of the machine with cable of insufficient cross section and/or excessive length, this can lead to material damages or personal damages.



### 2.6.2 Safety notes operation

In order to work as safely as possible, you need to wear appropriate clothing and equipment at work. The clothing must be appropriate and not disturbing. Do not wear clothing that can get caught up. Secure long hair e.g. with a hair net.

#### **Caution! Wear ear protection!**



During operation, a hearing protection must be worn.

For the ROLL-STRIPPER RO-2 following sound value was determined according to DIN 45645:  
Use operating LEQ = 73 dB (A)

The generated noise during machine operation depends on various factors.  
Local conditions such as room size and ground conditions affect the noise.

#### **Caution! Wear protection eyeglasses!**



For eye protection safety glasses must be worn during operation and during all work.

#### **Caution! Wear suitable work clothes!**



Wear during the operation and for all work any loose clothing. These can be caught in moving parts.

#### **Caution! Wear safety shoes!**



The wearing of safety footwear protects against serious foot injuries.



Keep hands, feet and not sticking parts of the clothes far from the machine parts located in work. The parts in movement of this machine can cause heavy injuries and/or damages.



During the work no person shall be stay in front of the machine!  
Flooring residues must be cleared with a broom or shovel off the track of the machine.



With the use of a not completely mounted machine injuries can originate to persons and/or things. Do not use the machine, before this has been completely mounted. Keep all connection elements closed.



Do not screw or rivet signs on the machine, you can destroy the protective insulation! We recommend stickers!



Maintenance and repair by uncertified staff can lead to injuries or damages and reduces all guarantee achievements.



Should the machine be exposed to water or rain, it can come to deaths by electric shock. The machine must be stored in a dry building.

### 3 Scope of delivery

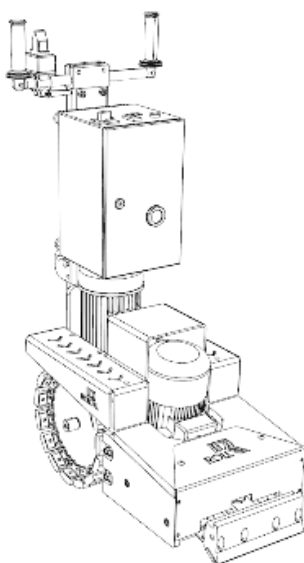

- 17.18000 ROLL-STRIPPER RO-2
- 43.00415 2x Transport wheel incl. quick release axles (dismounted)
- 43.00435 2x Handgrip for transport
- 10 m connection cable 3x2,5mm<sup>2</sup>
- 17.18400 Stripper Tool 250x80x2mm flat
- 17.18440 Stripper Tool 250x80x2mm U-shape
- Bag with tool kit
- Operation manual

### Accessories

#### 3.1 Stripper tools



Choosing the right stripper tool

Choosing the right tool depends on the floor covering and the subfloor and is crucial for efficient performance of ROLL-STRIPPER RO-2. The harder the surface and the harder it is connected with the ground, the narrower the tool should be selected.



	Article	Description
	17.18400	Stripper tool 250x80x2mm flat
	17.18410	Stripper tool 300x80x2mm flat
	17.18420	Stripper tool 350x80x2mm flat
	17.18430	Stripper tool 250x80x2mm U-shape A (bevel up)
	17.18440	Stripper tool 250x80x2mm U-shape B (bevel down)
	17.18450	Stripper tool 350x80x2mm U-shape A (bevel up)
	17.18460	Stripper tool 350x80x2mm U-shape B (bevel down)
	17.18470	Stripper tool 250x80x2mm shape flex
	17.18480	Stripper tool 250x120x2mm trapezium shape

### 3.2 Optional accessories for the **ROLL-STRIPPER RO-2**

17.17750 Loading ramps set of 2 pieces

## 4 Description of the **ROLL-STRIPPER RO-2**

### 4.1 Important components of the **ROLL-STRIPPER RO-2**

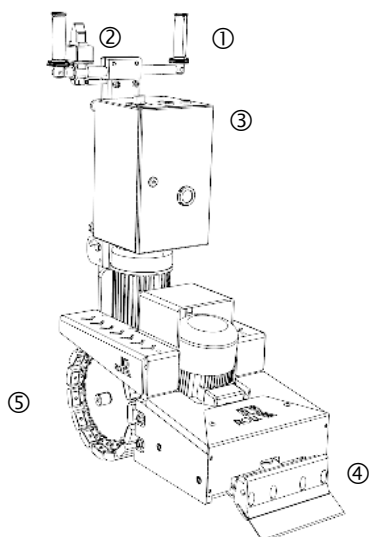

- ① Individually adjustable handle
- ② Joystick operation
- ③ Switch cabinet with ports
- ④ Striking mechanism with tool holder
- ⑤ Chain wheels with rectangular rubber elements

### 4.2 Important components of the joystick

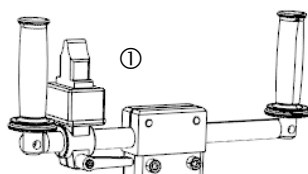

- ① Joystick
- ② Clamping lever for locking the joystick



②

### 4.3 Important components of the switch cabinet

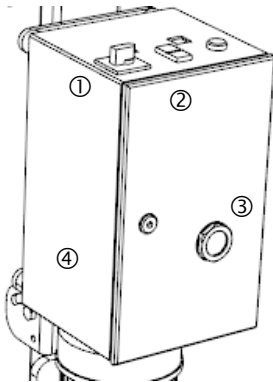

- ① ON/OFF rotary switch
- ② Toggle switch for stroke motor on / off
- ③ Sight glass to the frequency converter
- ④ Frequency converter (inside)

### 4.4 Technical specifications:

Drive motor (left/right):	1,5 kW, 230 volts
Torque:	327 Nm
Stroke engine:	1,1 kW, 230 volts
Blow count:	2500 beats per minute (bpm)
Stroke size/length:	Adjustable in 3 steps
Working width:	Up to 350 mm
Dimensions:	380 x 760 x 1100 mm
Weight:	195 kg

### 4.5 Safety devices

#### 4.5.1 Electrical safety devices



To avoid danger the ROLL-STRIPPER RO-2 is equipped with electrical safety devices.

- 4.5 Under voltage release on the striking mechanism: The toggle switch for turning on and off of the striking mechanism is equipped with an under voltage release. In case of power failure, the switch triggers. After the power is restored the switch must be turned on manually. A switching on without sufficient supply voltage is not possible.

Restart interlock: By the restart interlock the release of the device is prevented when the power is turned on or interrupted and switched on again.

Dead man switch: By the dead man switch on the joystick control the ROLL-STRIPPER RO-2 can only be moved by pushing the joystick forward or backward. When you release the joystick and the machine stops.



### 4.5.2 Mechanical safety devices



To avoid danger the ROLL-STRIPPER RO-2 is equipped with mechanical safety devices.

Danger by the chains. Keep hands, feet, and unattached parts of the clothes away from the chains. To avoid danger by the chains the ROLL-STRIPPER RO-2 is equipped with safety devices:

- Footboards right/left

Danger by moving machine parts. Keep hands, feet, and unattached parts of the clothes away from the moving parts. The moving parts of this machine can cause serious injury and / or damage. To avoid danger by the moving machine parts the ROLL-STRIPPER RO-2 is equipped with safety devices:

- Cover plates
- Bottom plate

## 5 Assembly

### 5.1 Safety notes assembly



**Caution! Material damage possible!**

**The work must be done sensitively and with the right tools.**

The ROLL-STRIPPER RO-2 is delivered fully assembled.

The assembly of the stripper tool, as well as the electrical connection to the mains is carried out in the workplace only.

## 6 Loading and transport

Often, it is essential that the machine has to be transported to a application site. For this, use the supplied transport wheels (Art. 43.00415)

**Total weight of the machine:** 195,0 kg



**Caution, Fragile!**

**Do not transport the machine without securing it onto the load area.**



### 6.1 Safety notes loading and transport



Insufficient preparation for transport and inadequate cargo securing can lead to serious personal injury and damage!

- Always remove the stripper tool for transport.
- Loading and unloading of the ROLL-STRIPPER RO-2 perform on firm ground.
- Use suitable ramps.
- Drive the ramp slowly. Nobody should stay behind the ramp and in front of the machine (danger of tipping).
- Use for the transport only appropriate vehicles.
- Secure the ROLL-STRIPPER RO-2 safe on the loading area, for example with wedges, ropes and chains.
- Check periodically lashing equipment, but at least:
  - before each use
  - at least once a year by skilled technician



**Caution, damage due to improper storage or transport possible!**

If the device has been transported in extreme temperatures, it requires at least 2 hours of acclimatization prior to operation.

### 6.2 Transport using the transport wheels

- Make sure that the transport wheels are securely fastened.
- Move the ROLL-STRIPPER RO-2 only on the handles of the guide rod.

#### 6.2.1 Transport wheels assemble / disassemble



##### **Caution!**

Switch off the machine with the ON-/OFF rotary switch at the switch cabinet and pull out the plug from the power connection!

1. Lay the ROLL-STRIPPER RO-2 with the upright drawbar to the back.
2. Hold the transport wheel ① with one hand and open the clamping nut with lever ② counter clockwise until the axle with wheel drawn off from the shaft.
3. Repeat the process with the second wheel.
4. Reassemble in reverse order.

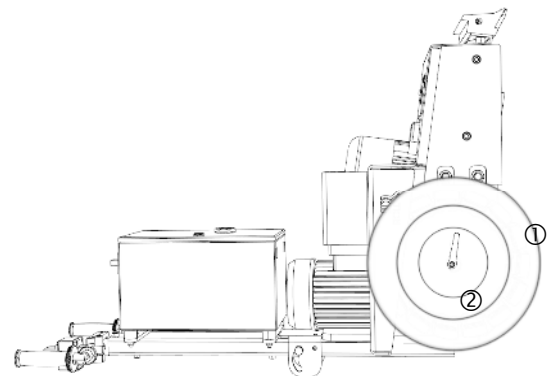



### 6.3 Transport in motor vehicles

For the transport in motor vehicles with a low loading floor height, the handle can be folded backwards.

1. Loosen the hexagonal screw ① right and left on the drawbar joint a few turns counterclockwise and set the drawbar back.
2. Close the hexagonal screws clockwise to fix the drawbar in this position.

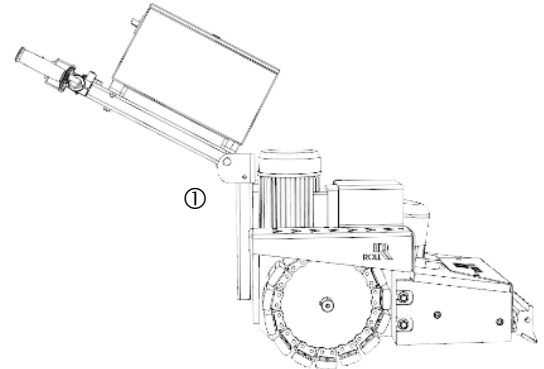

### 6.4 Transport inside the building

For easy transport in the building of ROLL-STRIPPER RO- 2 can be divided into two parts.

1. Lay the ROLL-STRIPPER RO-2 to the back.
2. Mount the supplied hand grips ① right and left at the stroke mechanism.
3. Loosen the plug connection ② to the stroke engine at the bottom of the switch cabinet and pull out the cable from the cover.  
Loosen the two hexagonal screws ③ right and left at the side plates a few turns counterclockwise.
4. Pull out the front part the including the engine of the guide.
5. The front part can now be carried by two people.
6. Mount the transport wheels ④ as described in chapter 6.2.1.  
The rear part can now be moved to the site, or pulled up on stairs.

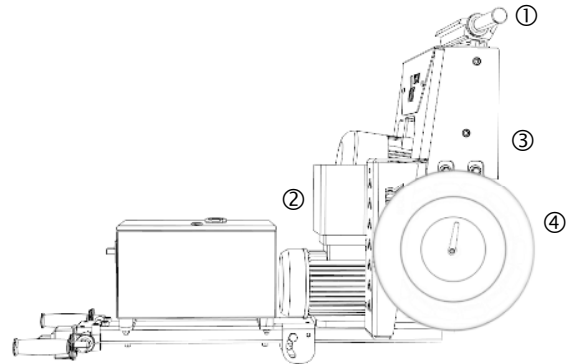

### 6.5 Loading using a ramp

- The ramp must be clean, dry and free of grease and oil.
- Place the ramp safe at the vehicle and, if possible, save it from slipping.
- Place the ROLL-STRIPPER RO-2 at the end of the ramp.

### 6.6 Loading in an elevator



Due to the compact dimensions the ROLL-STRIPPER RO-2 is suitable for the transport in an elevator. Make sure before the transport that the elevator is rated for a minimum weight of 195.0 kg.

If available, for safety reasons a freight elevator should be used.

### 6.7 Transport securing



Basically, the relevant directives and standards to secure cargo apply to transport the cargo safely and securely.



Note for securing loads the dynamic forces etc. occur when starting, braking, cornering.

Lashing equipment must not be overloaded because of breakage or damage.

Never knot lashing equipment, as significant loss of strength is the result.

Damaged or overloaded lashing equipment may not be used. The strength the lashing equipment is no longer guaranteed.

Check the pretension of the lashing equipment after a short driving distance and throughout the journey, and retighten if necessary.

## 7 Operation

### 7.1 Preparing the machine

#### 7.1.1 Adjustment on the drawbar

For a precise and convenient operation of the ROLL-STRIPPER RO-2, the correct setting of the drawbar is important. The drawbar is multi-adjustable.

Height adjustment  $\updownarrow$  :

By pulling out the guide rod with sprag ② the drawbar can be increased by 4cm.

1. Open the 2 allen screws ① on the back side of the drawbar and pull them out.
2. Pull out the guide rod with sprag ② approx. 4 cm to the top and insert the 2 allen screws ① again.
3. Fasten the allen screws.

Angle adjustment  $\leftrightarrow$  :

The guide handles ③ can be tilted forward or backward.

Loosen the 2 allen screws ④ at the sprag ②.

1. Move the guide rod with handles ③ forward or backward to the optimal position.
2. Fasten the 2 allen screws at the sprag ②.

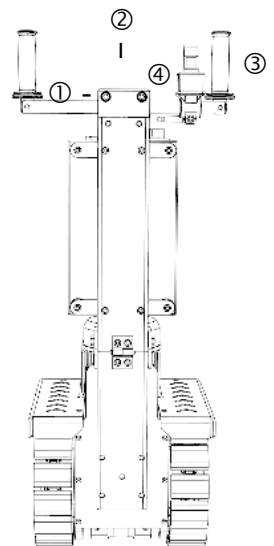

#### 7.1.2 Adjustment on the joystick

The joystick can be adapted to the operator.

1. Loosen the clamping lever ① at the joystick ②.
2. Move the joystick ② forward, backward or to the side to the optimal position.
3. Fasten the clamping lever ①.

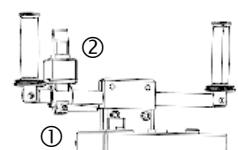



### 7.1.3 Connect to mains



- Connect the ROLL-STRIPPER RO-2 with the supplied extension cable to the mains.
- Lay the extension cable in such a way that it cannot be driven over when working.
- When turning the cable should always be kept raised above the machine so that it cannot be driven over.



With the sight glass at the switch cabinet you have the possibility to check whether the ROLL-STRIPPER RO-2 is joined to the mains.



- Turn the rotary switch on the control panel to position "ON" to turn on the controller.
- Look through the sight glass on the switch cabinet if the display on the frequency converter is lit.

### 7.2 Prepare the ground

- In order to effectively remove the floor covering, it is first cut in the working direction into strips. The width of the strips depends on the width of the stripping tool being used.
- For soft floor coverings optionally the U-shaped stripper tool can be used. This eliminates the need for strip cutting.
- At the place at which the machine is placed, an starting point for the ROLL-STRIPPER RO-2 should be cut parallel to the stripper tool.

### 7.3 Starting the machine

#### 7.3.1 Switch on/off the regulation

The regulation of the ROLL-STRIPPER RO-2 is switched on/off with the rotary switch ① "ON/OFF" at the switch cabinet.

Working steps:

- Turn the rotary switch ① at the switch cabinet to position "ON" to turn on the regulation.
- Turn the rotary switch ① at the switch cabinet to position "OFF" to turn off the regulation.

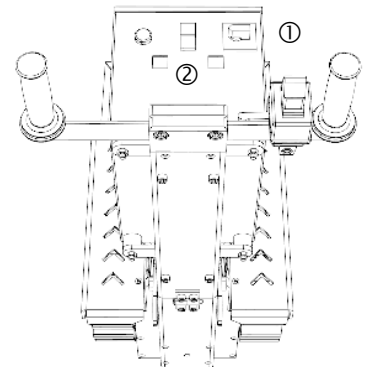

#### Caution

Once the regulation of the ROLL-STRIPPER RO-2 is turned on, the ROLL-STRIPPER is ready for use. Control commands are performed by pushing the joystick.

#### 7.3.2 Switch on the striking mechanism

The striking mechanism and thus the stripper tool is powered by a motor which is switched on and off with the toggle switch ② at the switch cabinet.



Let the striking mechanism switched on only for the removal process to avoid unnecessary tool wear and injury.

Working steps:

- Push the toggle switch ② in position „I“ to switch on the striking mechanism.



- Push the toggle switch ② in position „0“ to switch off the striking mechanism.

### 7.3.3 Start the stripping (removal) process

After the ROLL-STRIPPER RO-2 was prepared and the stripper tool was placed at the previously cut starting point the stripping process can start.

Working steps:

- Push the joystick at the guide handle forward to drive forward.
- Pull the joystick at the guide handle backward to drive backwards.



See also chapter "*Control of the ROLL STRIPPER RO-2*"

### 7.4 Control of the ROLL-STRIPPER RO-2

Forward / Backward:

The forward and backward movement is carried out with the joystick ① at the guide handle.

- Push the joystick ① forward or pull it back to drive forward or backwards.

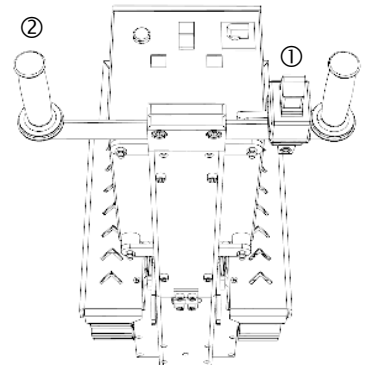

The reverse speed is 50% faster than the forward speed to move the ROLL-STRIPPER RO-2 more effectively.



#### **Caution! Wear safety shoes!**

The wearing of safety footwear protects against serious foot injuries.

Steering movements:

The steering movements are performed with the guide handles ② at the guide rod.

- Twist the drawbar in the desired direction with the guide handles ② to perform a steering movement.

Turn on the striking mechanism:

- Push the toggle switch ① at the switch cabinet in position „I“ to switch on the striking mechanism.
- Push the toggle switch ① at the switch cabinet in position „0“ to switch off the striking mechanism.

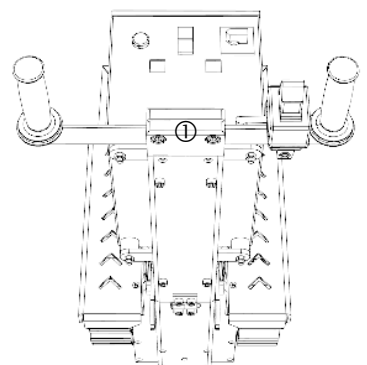

#### **Attention! Risk of injury!**

Risk of crushing when turning and starting on a wall!  
Always work with the machine away from the operator.





### **Attention! Overrun by the drive motor!**

After releasing the joystick, the device moves a few cm further.

#### **7.5 Tips**

- Make sure that the stripper tool is always sharp. Keep your work area clean and free of debris to avoid unnecessary wear of the tool and to allow optimal traction of the chains.
- For soft subfloors use the stripper tool with bevel down to avoid damages of the subfloor.
- Place the stripper tool not too steep at soft surfaces.
- Cut the strip width of the floor covering not wider than the used stripper tool. In case of stubborn bonded coverings cut narrower strips.
- Work alignment from the middle of the room to the wall.
- Take care of the power cord. If possible work away from the socket.

## **8 Service and Maintenance**

### **8.1 General**

The required tools for the servicing, care and maintenance described below are included with the machine.

ROLL has intended care and maintenance for the ROLL-STRIPPER RO-2. Only these described below works can be performed.

For this, the following instructions must be adhered to. The use of original spare parts ensures the reliable use of the machine in the future.

Following works are intended:

- Cleaning and maintenance (chapter 8.2)
- Changing the stripper tool (chapter 8.3)

### 8.2 Cleaning and maintenance



#### **Caution!**

Switch off the machine before cleaning with the ON-/OFF rotary switch at the switch cabinet and pull out the plug from the power connection!

Once per week - with frequent use more often - carry out:

- Blow out the engine compartment from the outside with dry compressed air
- Remove the floor covering leftovers
- Clean the chains and chain segments

From time to time:

- Check the mobility of the moveable tool axis by rotational movement
- Blow out the engine compartment inside with dry compressed air
- Check the bottom plates for damage



#### **Caution!**

**Replace the wear parts timely!**

### 8.3 Changing the stripper tools



#### **Caution!**

Switch off the machine before cleaning with the ON-/OFF rotary switch at the switch cabinet and pull out the plug from the power connection!



#### **Caution!**

Danger of cutting for the hands! Wear protective gloves!



1. Lay the ROLL-STRIPPER RO-2 to the back.
2. Loosen the 4 allen screws ① at the tool holder ②.
3. Pull out carefully the stripper tool ③.
4. Insert carefully the new stripper tool ③.

Please note that the stripper tool is inserted centrally into the tool holder, and just in the guidance of the lower clamp.



5. Fasten the 4 allen screws ① at the tool holder ②.

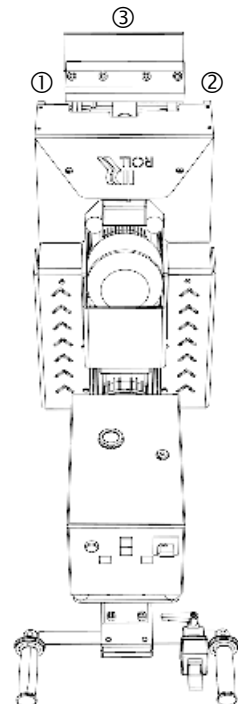



### 8.8 Safety notes for cleaning and maintenance



#### **Note!**

*For all works the following can be applied in general:*

- *The works must be done by trained personnel only.*
- *Any work performed on the electrical equipment may be carried out by skilled electricians only.*
- *The utilization of original parts guarantees the necessary technical specifications.  
The spare parts catalog you will find at the end of this manual.*



#### **Caution!**

**Material damages are possible!**

**The works have to be done carefully and with suitable tools, so that no other parts of the machine are damaged during the possible slipping of the tool.**



### 9 Instruction of the operator

As the operator, you are responsible for the proper and intended use by trained personnel. Since improper use dangers to persons and damage can occur, a thorough and comprehensive training of people is required. The responsible for the training of operators is the entrepreneur who instructed the operator to work with the ROLL-STRIPPER RO-2.

#### 9.1 Theoretical instruction

- ☐ Handed out the operation manual.  
This operating manual is as the basis for the instruction of the operator.
- ☐ Made aware on the safety notes  
according chapter 2 of this operation manual.
- ☐ Checked the scope of supply according chapter 3 of this operation manual.  
Scope of supply complete.
- ☐ Explained the important components of the ROLL-STRIPPER RO-2.  
According chapter 4 "Description of the ROLL-STRIPPER RO-2" of this operation manual.
- ☐ Made aware on the safety notes  
According chapter 4.5 of this operation manual.

#### 9.2 Practical instruction

- ☐ Instruction at the ROLL-STRIPPER RO-2
  - Explanation of the components
  - Explanation of the dangerous points
  - Explanation of the safety notes
  - Response to malfunctions
  - Assembly according chapter 5 of this operation manual
  - Startup according chapter 7 of this operation manual
- ☐ Practice at the ROLL-STRIPPER RO-2
  - Sensitive driving with the ROLL-STRIPPER RO-2
  - Steering the ROLL-STRIPPER RO-2
- ☐ Maintenance of the ROLL-STRIPPER RO-2
  - Changing the stripper tool according chapter 8.3 of this operation manual
  - Cleaning and maintenance according chapter 8.2 of this operation manual

Instruction was conducted on: \_\_\_\_\_ in: \_\_\_\_\_

\_\_\_\_\_  
Instructor: Name | Signature

\_\_\_\_\_  
Operator: Name | Signature

### 10 Guarantee and liability

ROLL ensures a guarantee and liability are in accordance with our currently valid general business and sales conditions. The guarantee runs out after 12 months from purchase date.

We reject any guarantee claims for tools which are not in their original condition, or for altered or changed tools or which are not used in accordance to the intended use.

We guarantee free maintenance of this machine when getting carriage paid, in case of damages due to manufacturing defects or material defects; provided that the machine is correct used and not changed or altered. Wearing parts are not under warranty.

The guarantee claim expires:

- In case of damages caused by improper operation and utilization other than intended use.
- In case of incorrect assembly, intervention of unauthorized persons or utilization of accessories or replacement parts that are not ROLL original parts

We strongly recommend the use of genuine ROLL spare parts and accessories even after expiration of the warranty period. This is the only way to ensure an impeccable operation of your machine.



**Note!**

*Check the shipment in order to ensure that it is complete in accordance with the chapter 3 „**Scope of delivery**“, and inform your dealer immediately, should any shipment be incorrect.*



### 11 *Exploded View - Linear unit / stroke engine*

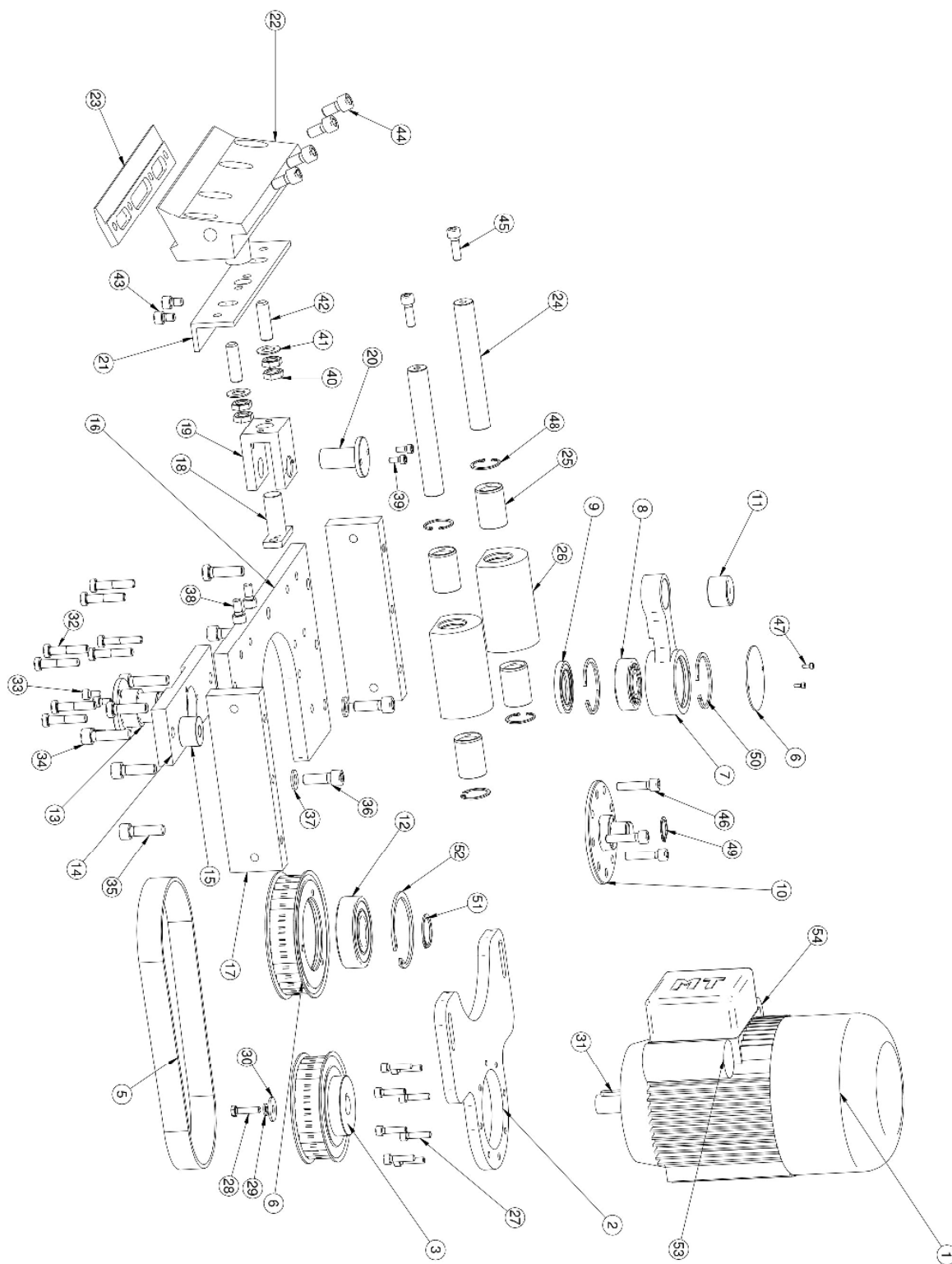

**Orders indicating the item number!**